



Outer Tension Bushes

Type PN3500

Pentz Outer Tension Bushes are slotted hollow cylinders, made in the same way as Inner Bushes previously described. They are pressed onto shafts to achieve an increased hard wearing surface area.



PN3500 – Areas of Application

Pentz Outer Tension Bushes are made in order to increase the longevity of bearings subjected to heavy duty working conditions.

Easy replacement makes for increased life of assembly and minimum maintenance costs.

Assembly is facilitated by the single inner chamfer.

When used in conjunction with Inner Tension Bushes at least one of the Bushes must have slant or arrow shaped slots.

Conveying machinery in harsh environments are a particular application.

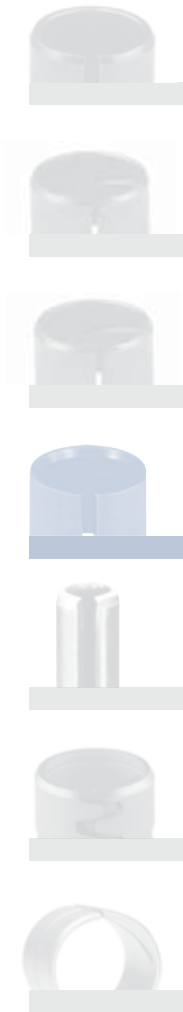

Outer Tension Bushes Type PN3500

The inner diameter of an Outer Tension Bush is smaller by a fixed value than the diameter of the shaft journal.

Its retention force is generated by the Bush diameter, length and wall thickness.

We offer facilities to grind the outer diameter in order to achieve closer tolerances.

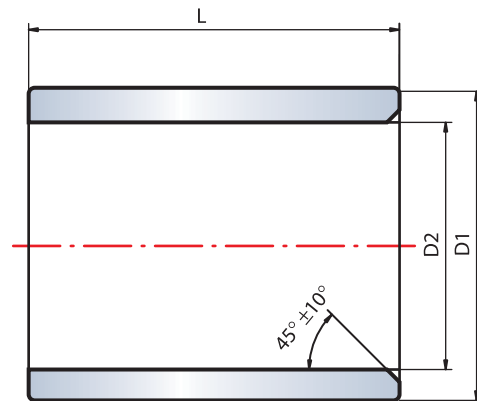

Sizes D2		10	18	30	40	50	65	80	100	120	140	160	180
		to	to	to	to	to	to	to	to	to	to	to	to
		18	30	40	50	65	80	100	120	140	160	180	200
ISO tolerance D1	a 12	-0,470	-0,510	-0,560	-0,570	-0,640	-0,660	-0,730	-0,760	-0,860	-0,920	-0,980	-1,120
		-0,290	-0,300	-0,310	-0,320	-0,340	-0,360	-0,380	-0,410	-0,460	-0,520	-0,580	-0,660

Tolerance after assembly on shaft, D1 = h8. For more exacting applications tolerance on D2 can be ground up to tolerance H10.

Pre-tension D1 (before assembly)

Sizes D2		10	35	55	90	115
		to	to	to	to	to
		35	55	90	115	180
Diameter	D1	-0,5	-0,8	-1,0	-1,3	-1,5

Length tolerances

Sizes D2		10	50	100
		to	to	to
		50	100	250
Length L	> 100	-1	-1,5	-2
	< 100	-1,5	-1,5	-2

All dimensions in millimetres.



AG
Straight Slot

- For slow running and oscillating work



AS
Inclined Slot

- For regular rotary motion applications



AP
Arrow Slot

- As Type AS, but mainly used for longer lengths